

SWITCH BOARD

RS-142

Note: For operation of the units, refer to the N-8000 series operating instructions.

1. GENERAL DESCRIPTION

The RS-142 is a switch board to be connected to the 2-Core Shielded Substation Interface Unit. You can make desired switch panels to meet intended purposes by combining the RS-142 with the separately prepared operation panel having 2 switches to be used as call buttons.

The RS-142 features handset conversations by using the RS-141 indoor-use Option Handset in combination.

2. CONNECTIONS

2.1. When the Option Handset Is Not Used

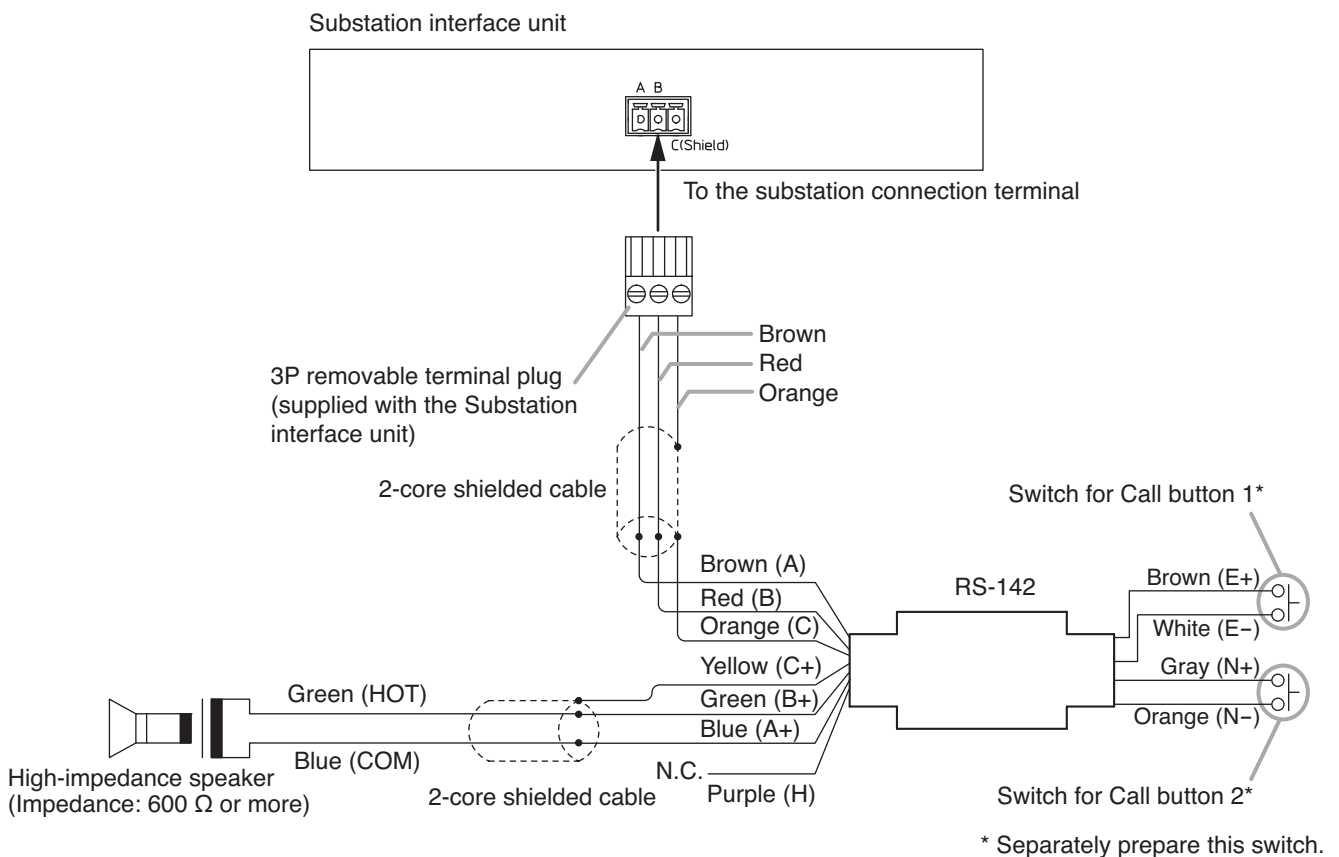

Note

Cut out the unused Wire (purple) to avoid short-circuiting.

2.3. When the Option Handset Is Used in Combination

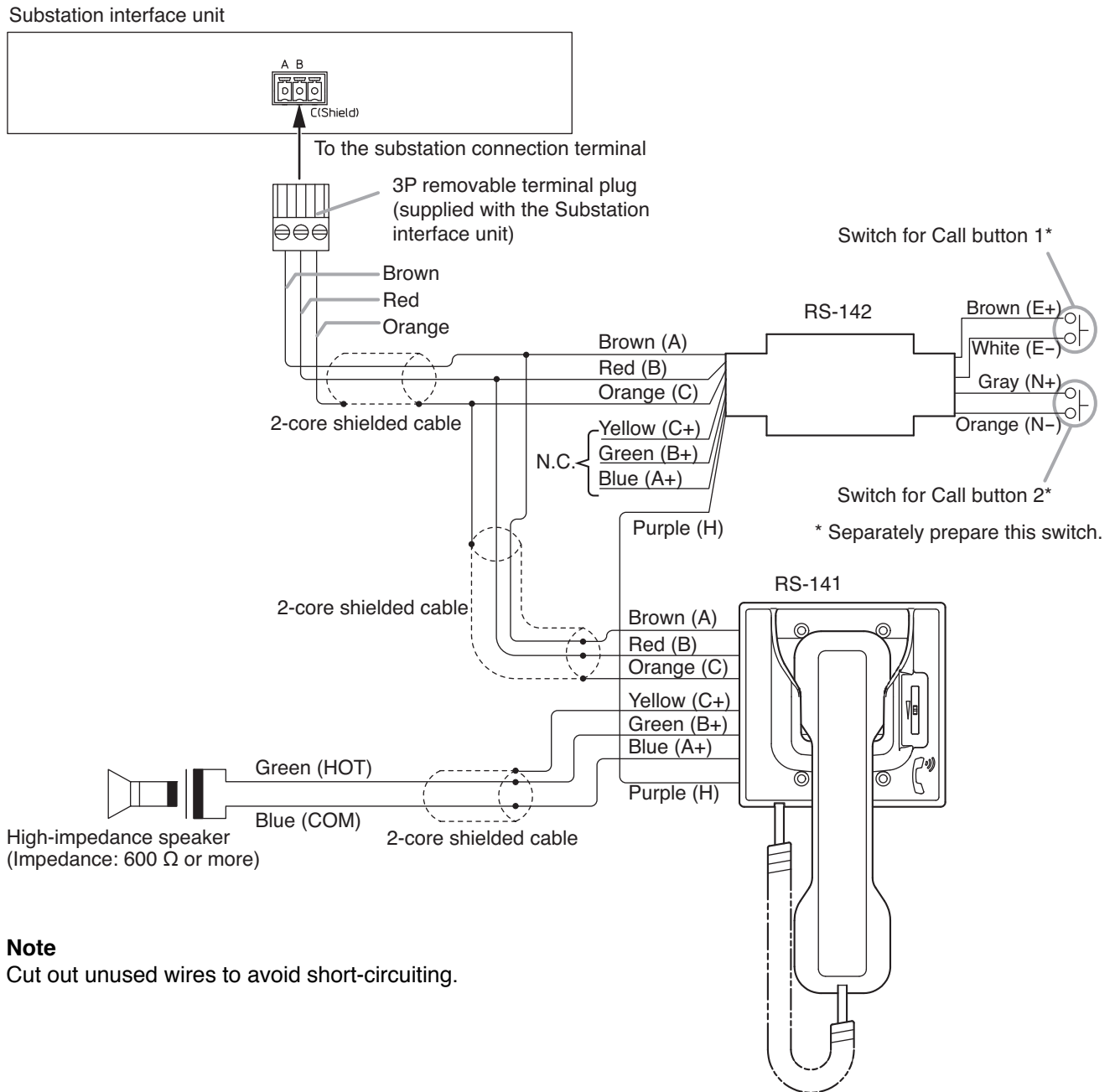

3. INSTALLATION

3.1. Switch Board Installation

3.1.1. Dimensional diagram

Unit: mm

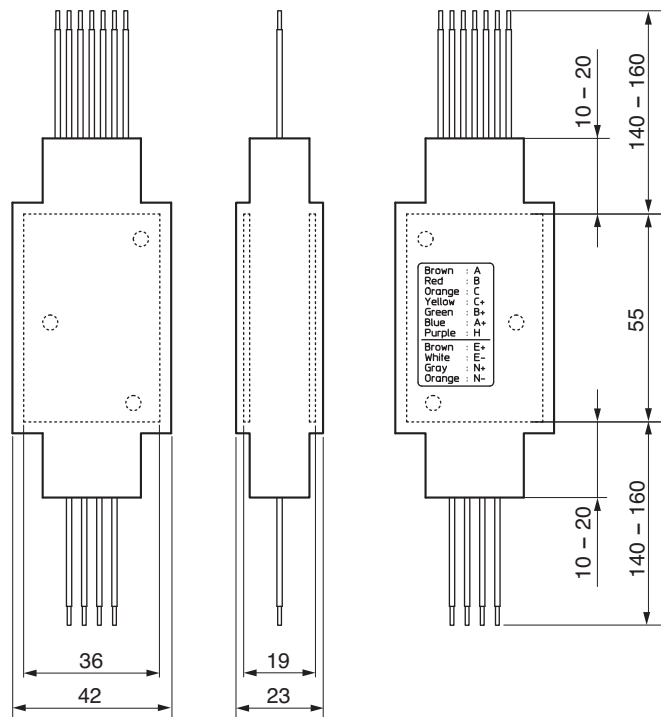

3.1.2. When Making the Switch Panel to Be Combined with an Electrical Box

Put the RS-142 in the YC-801 Flush-mount box mounted in the wall.
Then, connect the cables from RS-142 to the switches mounted on the operation panel separately prepared.

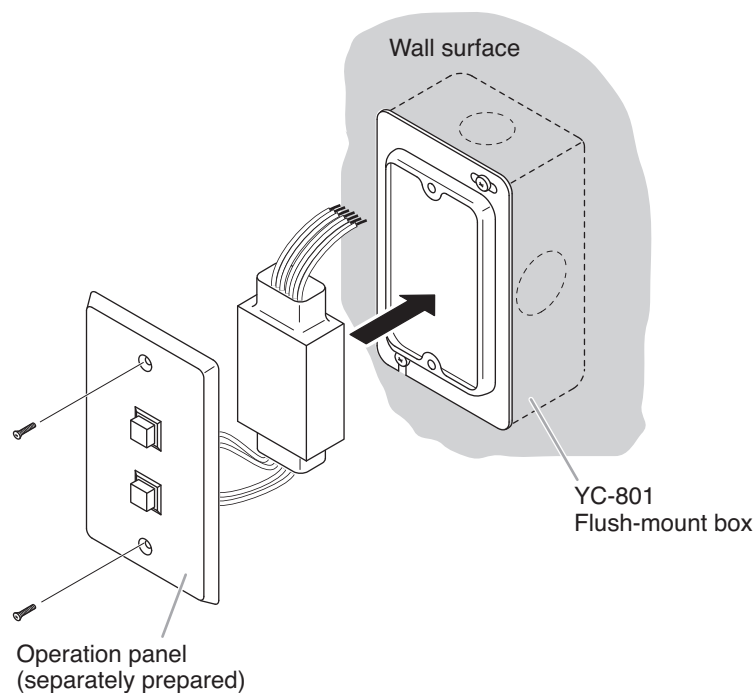

Note

When using the PA paging function, keep the switch panel as far away from the PA paging speaker as possible to avoid acoustic feedback.

3.2. Option Handset Installation

Mount the option handset to an electrical box mounted in the wall.

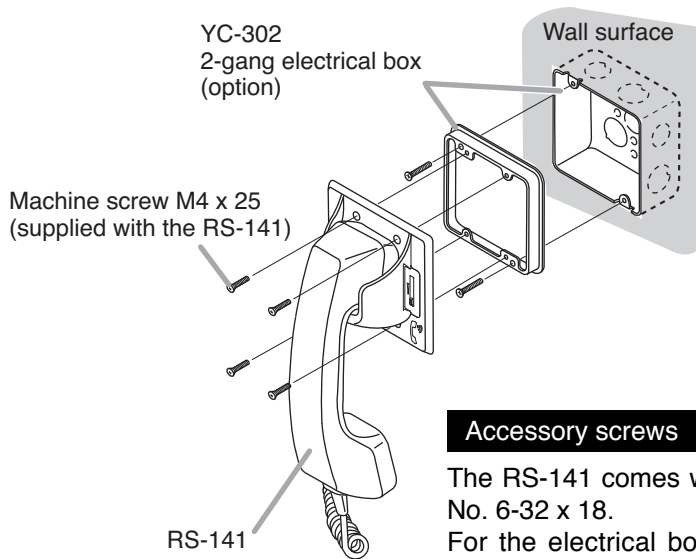

Accessory screws

The RS-141 comes with 2 types of screws: M4 x 25 and UNC No. 6-32 x 18.
For the electrical box provided with unified threads, use the UNC No. 6-32 x 18.

[Dimensional diagram]

Unit: mm

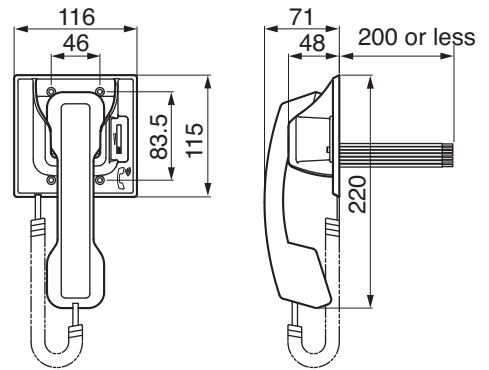

4. SPECIFICATIONS

Call Button Wiring	4 cables (for 2 momentary switches)
Wiring	2-core shielded cable
Transmission Range	500 m/ø0.5 mm (AWG24), 800 m/ø0.65 mm (AWG22), 1300 m/ø0.9 mm (AWG19)
Operating Temperature	0 to +40°C
Weight	30 g

